



FUNCTION & EVENTS PACKAGES



---

WELCOME TO THE GATSBY  
VENUE FLOOR PLAN & CAPACITIES  
OUR FUNCTION SPACES  
FUNCTION CATERING OPTIONS  
HOW TO FIND US

---



WELCOME TO

*The*  
**G**atsby

A LITTLE PARTY NEVER KILLED  
NOBODY  
- MR. GATSBY

The Gatsby is our decadent nod to the roaring 1920's, offering everything that you would expect from a high end whiskey bar. With both inside and outside seating areas, The Gatsby is fast becoming one of the most instagrammed locations in Brisbane.

Want to throw your own Gatsby themed event? You send out the invitations and we can do the rest. From 1920's dancing girls to a burlesque show! Bespoke cocktails from our mixologists or throwing a faux casino night, our team can get it done. Want a grand piano player to set the scene? You let us know and we can make the magic happen.

The Gatsby can hold up to 250 people and is available for exclusive venue hire or we can accommodate smaller groups starting from 20 guests.











# VENUE FLOOR PLAN, CAPACITIES & SPECS

THE SOCIALITE ROOM	SEATED - 6-10PAX
THE DRESSING ROOM	COCKTAIL - 8-20PAX
THE TERRACES	COCKTAIL - 30-40PAX
HALF VENUE	COCKTAIL - 100PAX
FULL VENUE	COCKTAIL - 250PAX





## HALF VENUE

### COCKTAIL- 100PAX



For a grand scale celebration worthy of Mr Gatsby himself, The Gatsby is available for half-venue hire. From the moment your guests ascend the stairs, they'll be whisked away into a world of sophistication and indulgence. Ideal for larger groups, our half-venue hire can accommodate up to 100 guests.

Soak up The Gatsby's rich ambience from the privacy of your sophisticated space combining a mixture of high cocktail tables and booth seating, complete with direct access to the bar allows guests to savour in our bespoke food and beverage packages.

Indulge your guests in a first-class collection of whiskeys, aged liqueurs and cocktail concoctions guaranteed to impress.

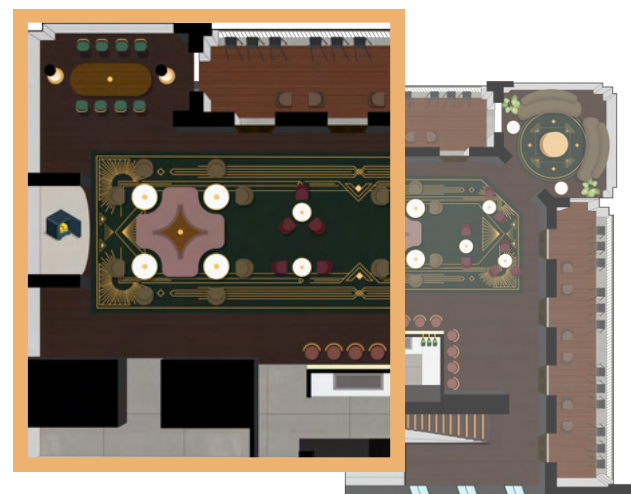





# FULL VENUE

COCKTAIL- 250PAX



Ascend the ranks of the upper class as you climb the stairway to The Gatsby. Guests will be instantly be embraced in an intimate ambience, reminiscent of the roaring twenties grandeur.

The venue’s extravagant design and décor flow from the cosy interior to the airy exterior of the covered outdoor terrace. The Gatsby is a trove of spaces built for indulgence, from it’s luxurious velvet booths, glamorous bar, and dining room, through to the sealed historic bank vault.

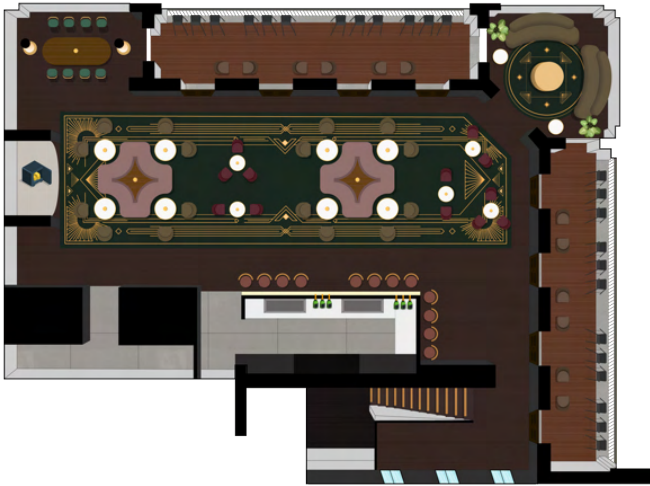



## FUNCTION CATERING OPTIONS



With choices of delectable, mouthwatering canapes through to gourmet Food Stations complete with a full Chef experience and bespoke cocktails, we have packages starting from as low as \$80 per person, providing you with exceptional flexibility when it comes to catering your events.

For more detailed information on our food and beverage packages, please speak with one of our experienced team members who will help tailor a F&B package suitable to your event.

Contact Our Team on (07) 5619 8187







## HOW TO FIND US

### LOCATION DETAILS



740 ANN ST,  
FORTITUDE VALLEY QLD 4006



MAP

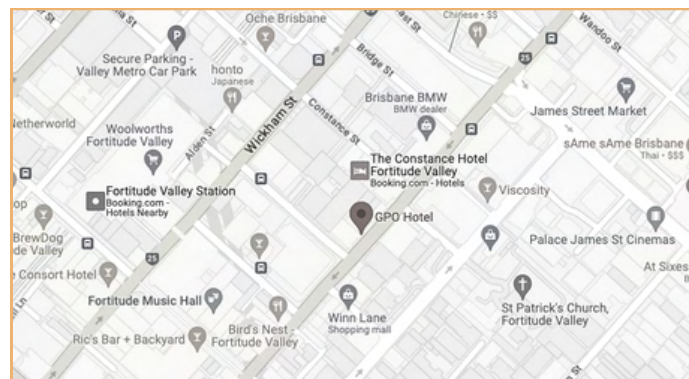

### BY TRAIN

Fortitude Valley Station  
From station, on foot — 500m  
Exit station to Brunswick St.  
Head south-east towards Wickham St.  
Turn right onto Ann St.  
The Gatsby will be on your left

### BY CAR

From car park, on foot — 190m  
Exit car park on Warner St.  
Head south-east onto Ann St.  
Turn right onto Ann St.  
The Gatsby will be on your left.