

# BOUJEE

BRISBANE



# BOUJEE

## PAGE OF CONTENTS

- 3. WELCOME TO BOUJEE
- 5. THE VENUE FLOOR PLAN & CAPACITIES
- 6-8. OUR FUNCTION SPACES
- 9. FUNCTION CATERING OPTIONS
- 10. HOW TO FIND US



# WELCOME TO BOUJEE

WHERE MOMENTS  
TURN INTO MEMORIES...

---

Boujee is the hottest new spot in Brisbane! Immerse yourself in an opulent setting, carefully curated to reflect the essence of sophistication and exclusivity.

Fancy having your very own nightclub for the evening for the ultimate VIP experience? Start in the main bar area before proceeding to our late-night area exclusively for your party. Step inside our very own Studio 54 with a roof full of disco balls and our luxurious booths and bottle service girls making you feel like a celebrity.

The Tax Office can hold up to 150 seated and 470 cocktail for a sole use function or if you're looking for something smaller, we can accommodate groups starting from 20 guests.









FLOOR PLAN & CAPACITIES

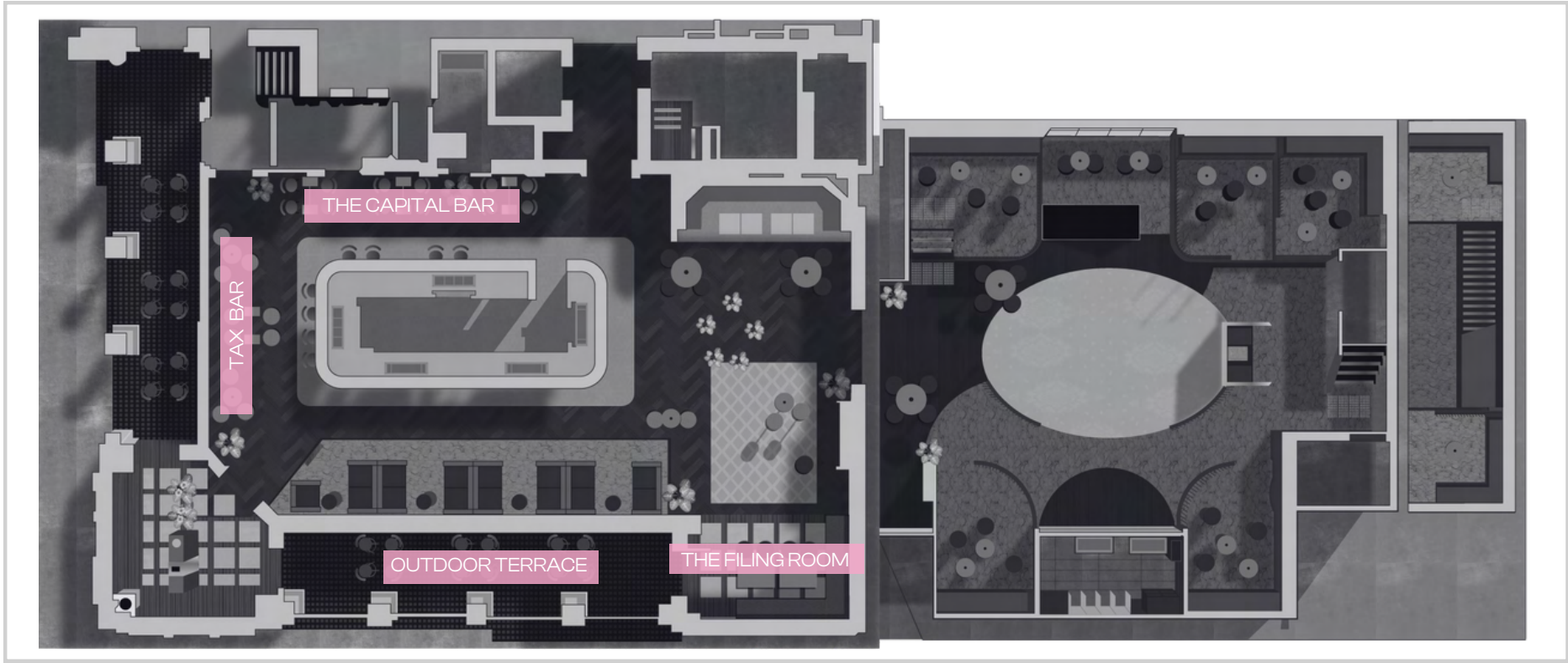

MAIN BAR

LATE NIGHT

THE CAPITAL BAR	COCKTAIL - 30PAX	MAIN BAR	SEATED - 80PAX COCKTAIL- 250PAX
TAX BAR	COCKTAIL- 30PAX	LATE NIGHT	SEATED - 70PAX COCKTAIL- 250PAX
THE FILING ROOM	COCKTAIL- 20PAX	FULL VENUE	SEATED - 150PAX COCKTAIL- 470PAX
OUTDOOR TERRACE	COCKTAIL- 40PAX		



## MAIN BAR

SEATED - 80PAX | COCKTAIL - 250PAX

Get ready to pay your dues at The Tax Office. The Main Bar offers exceptional function hire services, ideal for hosting corporate events with up to 250 attendees.

Whether you prefer a formal seated affair or a sophisticated cocktail-style gathering, The Main Bar caters to your every need. With exclusive hire available for events and functions, you can be sure that your celebration will be one for the books.

Indulge in our delectable food and beverage packages, meticulously curated to satisfy even the most discerning palates. Our staff will ensure that you and your esteemed guests are well-nourished and impeccably served throughout the evening. This unique venue exudes an ambiance that is both unconventional and enjoyable, leaving a lasting impression on all attendees.

Say goodbye to dull office cubicles and monotonous tax forms, you'll experience an atmosphere filled with positive energy, captivating melodies, and unforgettable moments.

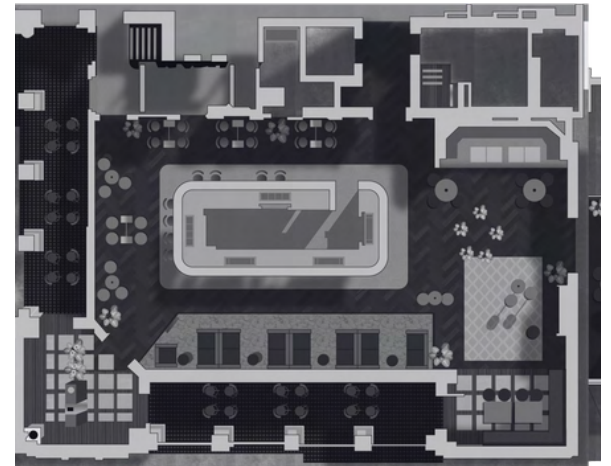



## LATE NIGHT

SEATED - 70PAX | COCKTAIL - 250PAX

Offering a more private affair, The Late Night is perfect for cocktail-style events for up to 250 guests and can be transformed into a formal sit-down celebration unlike any other, for up to 70 guests. This functional space features 7 luxurious booths, a well-appointed bar, and ample room for guests to mingle.

Allow your distinguished guests to savor an unforgettable experience as they revel in an evening of sophisticated enjoyment, where fine libations, graceful dancing, and lasting memories converge.

The Late Night is ready to set the scene for your next event. The multi-level room offers flexibility ideal for hosting birthday celebrations, corporate events, event activations and anything else in between.

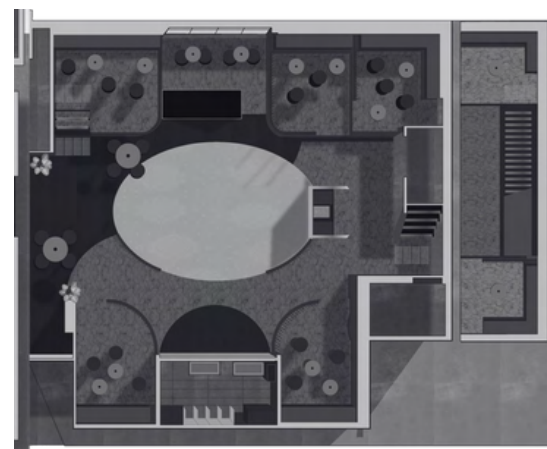

## FULL VENUE

SEATED - 150PAX | COCKTAIL - 470PAX

Looking to create a night where the good times never end? A night where the dance floor is filled with your closest friends right up until the delicate lights call closing time? The Tax Office full venue hire is the ultimate in day-to-night function hire. With room for 150 seated guests, or 470 guests cocktail-style, this venue is a play haven set to tantalise every taste.

With delicious food and beverage packages available, you and your guests will be well-fed and well-hydrated throughout the night. Weave your way from booth to bar and back via the dancefloor with exclusive reign of the entire venue's layout.

The possibilities are endless at the Tax Office, with entertainment and audio equipment available to elevate your event and truly dazzle your guests... no more dull office parties and memories you'd rather forget.

It's the ultimate choice for an impressive corporate event, raucous celebration or sophisticated gathering.

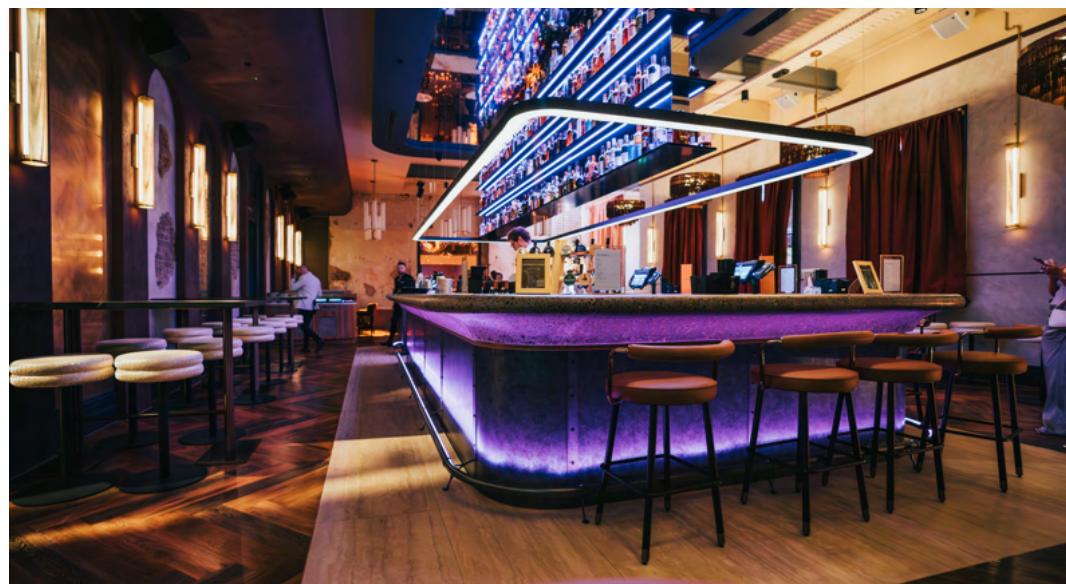
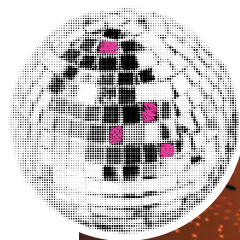



## FUNCTION CATERING OPTIONS

With choices of delectable, mouthwatering canapes through to gourmet Food Stations complete with a full Chef experience and bespoke cocktails, we have packages starting from as low as \$80 per person, providing you with exceptional flexibility when it comes to catering your events.

For more detailed information on our food and beverage packages, please speak with one of our experienced team members who will help tailor a F&B package suitable to your event.

Contact Our Team on (07) 5619 8187





# HOW TO FIND US

## LOCATION DETAILS

740 ANN ST,  
FORTITUDE VALLEY QLD 4006

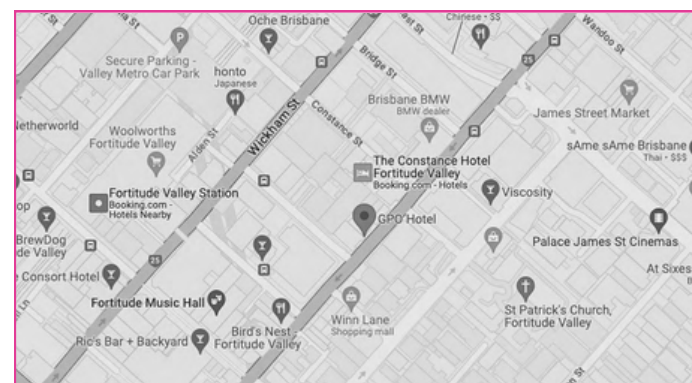

## BY TRAIN

Fortitude Valley Station  
From station, on foot — 500m  
Exit station to Brunswick St.  
Head south-east towards Wickham St.  
Turn right onto Ann St.  
The Tax Office will be on your left

## BY CAR

From car park, on foot — 190m  
Exit car park on Warner St.  
Head south-east onto Ann St.  
Turn right onto Ann St.  
The Tax Office will be on your left.

